

1503

United States Department of the Interior  
National Park Service

National Register of Historic Places  
Registration Form

This form is for use in nominating or requesting determinations for individual properties and districts. See instructions in *How to Complete the National Register of Historic Places registration Form* (National Register Bulletin 16A). Complete each item by marking "X" in the appropriate box or by entering the information requested. If an item does not apply to the property being documented, enter "N/A" for "not applicable." For functions, architectural classification, materials, and areas of significance, enter only categories and subcategories from the instructions. Place additional entries and narrative items on continuation sheets (NPS Form 10-900a). Use a typewriter, word processor, or computer, to complete all items.

1. Name of Property

historic name Prewett-Amis-Finney House

other names/site number Turnhill Farm

2. Location

street & number 2629 Pullen Mill Road

not for publication N/A

city or town Culleoka

vicinity

state Tennessee

code TN

county Maury

code 119

zip code 38451

3. State/Federal Agency Certification

As the designated authority under the National Historic Preservation Act, as amended, I hereby certify that this  nomination  request for determination of eligibility meets the documentation standards for registering properties in the National Register of Historic Places and meets the procedural and professional requirements set for in 36 CFR Part 60. In my opinion, the property  meets  does not meet the National Register criteria. I recommend that this property be considered significant  nationally  statewide  locally. (See continuation sheet for additional comments.)

Hubert L. Hays  
Signature of certifying official/Title

10/21/97  
Date

Deputy State Historic Preservation Officer, Tennessee Historical Commission  
State or Federal agency and bureau

In my opinion, the property  meets  does not meet the National Register criteria. ( See Continuation sheet for additional comments.)

\_\_\_\_\_  
Signature of certifying official/Title

\_\_\_\_\_  
Date

\_\_\_\_\_  
State or Federal agency and bureau

4. National Park Service Certification

I hereby certify that the property is:

- entered in the National Register.
  - See continuation sheet
- determined eligible for the National Register.
  - See continuation sheet
- determined not eligible for the National Register
- removed from the National Register.
- other, (explain:)

Edson H. Beall  
Signature of the Keeper

Date of Action

12/2/97

Prewett-Amis-Finney House  
Name of Property

Maury County, Tennessee  
County and State

**5. Classification**

**Ownership of Property**  
(Check as many boxes as apply)

**Category of Property**  
(Check only one box)

**Number of Resources within Property**  
(Do not include previously listed resources in count)

- private
- public-local
- public-State
- public-Federal
- building(s)
- district
- site
- structure
- object

Contributing	Noncontributing	
2		buildings
1		sites
		structures
		objects
3	0	Total

**Name of related multiple property listing**  
(Enter "N/A" if property is not part of a multiple property listing.)

N/A

**Number of Contributing resources previously listed in the National Register**

0

**6. Function or Use**

**Historic Functions**

(Enter categories from instructions)

DOMESTIC: Single Dwelling

DOMESTIC: Secondary Structure

FUNERARY: Cemetery

**Current Functions**

(Enter categories from instructions)

DOMESTIC: Single Dwelling

DOMESTIC: Secondary Structure

FUNERARY: Cemetery

**7. Description**

**Architectural Classification**

(Enter categories from instructions)

Other: Hall-and-parlor

Colonial Revival

**Materials**

(Enter categories from instructions)

foundation Stone

walls Weatherboard

roof Metal Shingle

other Aluminum

**Narrative Description**

(Describe the historic and current condition of the property on one or more continuation sheets.)

**8. Statement of Significance**

**Applicable National Register Criteria**

(Mark "x" in one or more boxes for the criteria qualifying the property for National Register listing.)

- A** Property is associated with events that have made a significant contribution to the broad patterns of our history.
- B** Property is associated with the lives of persons significant in our past.
- C** Property embodies the distinctive characteristics of a type, period, or method of construction or represents the work of a master, or possesses high artistic values, or represents a significant and distinguishable entity whose components lack individual distinction.
- D** Property has yielded, or is likely to yield, information important in prehistory or history.

**Criteria Considerations N/A**

(Mark "x" in all boxes that apply.)

Property is:

- A** owned by a religious institution or used for religious purposes.
- B** removed from its original location.
- C** moved from its original location.
- D** a cemetery.
- E** a reconstructed building, object, or structure.
- F** a commemorative property
- G** less than 50 year of age or achieved significance within the past 50 years.

**Areas of Significance**

(Enter categories from instructions)

ARCHITECTURE

**Period of Significance**

1810-1935

**Significant Dates**

1810, 1935

**Significant Person**

(complete if Criterion B is marked)

N/A

**Cultural Affiliation**

N/A

**Architect/Builder**

Unknown

**Narrative Statement of Significance**

(Explain the significance of the property on one or more continuation sheets.)

**9. Major Bibliographical References**

**Bibliography**

(Cite the books, articles, and other sources used in preparing this form on one or more continuation sheets.)

**Previous documentation on file (NPS): N/A**

- preliminary determination of individual listing (36 CFR 67) has been requested
- previously listed in the National Register
- Previously determined eligible by the National Register
- designated a National Historic Landmark
- recorded by Historic American Buildings Survey # \_\_\_\_\_
- recorded by Historic American Engineering Record # \_\_\_\_\_

**Primary location of additional data:**

- State Historic Preservation Office
- Other State Agency
- Federal Agency
- Local Government
- University
- Other

Name of repository:

MTSU, Center for Historic Preservation

Prewett-Amis-Finney House  
Name of Property

Maury County, Tennessee  
County and State

### 10. Geographical Data

Acreage of Property 6.0 acres Lynnville, TN 58 NE

#### UTM References

(place additional UTM references on a continuation sheet.)

1	<u>16</u>	<u>499940</u>	<u>3924100</u>	3	<u>        </u>	<u>        </u>	<u>        </u>
	Zone	Easting	Northing		Zone	Easting	Northing
2	<u>        </u>	<u>        </u>	<u>        </u>	4	<u>        </u>	<u>        </u>	<u>        </u>

See continuation sheet

#### Verbal Boundary Description

(Describe the boundaries of the property on a continuation sheet.)

#### Boundary Justification

(Explain why the boundaries were selected on a continuation sheet.)

### 11. Form Prepared By

name/title Robert M. Dunkerly and Carroll Van West  
organization MTSU Center for Historic Preservation date September 18, 1997  
street & number P. O. Box 80, MTSU telephone 615-898-2947  
city or town Murfreesboro state TN zip code 37132

#### Additional Documentation

submit the following items with the completed form:

#### Continuation Sheets

#### Maps

A **USGS map** (7.5 or 15 minute series) indicating the property's location

A **Sketch map** for historic districts and properties having large acreage or numerous resources.

#### Photographs

Representative **black and white photographs** of the property.

#### Additional items

(Check with the SHPO) or FPO for any additional items

### Property Owner

(Complete this item at the request of SHPO or FPO.)

name Sandy Finney  
street & number 2629 Pullen Mill Road telephone 615-987-2288  
city or town Culleoka state TN zip code 38451

**Paperwork Reduction Act Statement:** This information is being collected for applications to the National Register of Historic Places to nominate properties for listing or determine eligibility for listing, to list properties, and to amend existing listing. Response to this request is required to obtain a benefit in accordance with the National Historic Preservation Act, as amended (16 U.S.C. 470 *et seq.*)

**Estimated Burden Statement:** Public reporting burden for this form is estimated to average 18.1 hours per response including time for reviewing instructions, gathering and maintaining data, and completing and reviewing the form. Direct comments regarding this burden estimate or any aspect of this form to the Chief, Administrative Services Division, National Park Service, P. O. Box 37127, Washington, DC 20013-7127; and the Office of Management and Budget, Paperwork Reductions Projects (1024-0018), Washington, DC 20303.

United States Department of the Interior  
National Park Service

# National Register of Historic Places Continuation Sheet

Section number 7 Page 1

Prewitt-Amis-Finney House, Maury Co., TN

---

## VII. DESCRIPTION

The Prewitt-Amis-Finney House stands on a hill overlooking Fountain Creek in southeastern Maury County, Tennessee, about two miles south of Culleoka. Pullen Mill Road runs south of the home along the base of the hill. Constructed in 1810, the dwelling is a two story hall-and-parlor residence with white wood siding, two stone exterior gable end chimneys, and a stone foundation. It is considered the first hall-and-parlor house in the county, as well as one of the earliest dwellings remaining in Maury County. The house's setting is impressive as it looks out over the fields and pastures of Fountain Creek Valley. The original hall-and-parlor dwelling is well preserved and retains most of its architectural and historical integrity.

The dwelling rests on a slight slope to the north; therefore, the foundation is more exposed on the south elevation than on the north elevation. White-painted, hand beaded, yellow poplar siding covered all four sides of the house. In 1995, most of the siding on the north, east, and south elevations was replaced. The original 12" x 12" sills and 4" x 4" studs are also of yellow poplar. The sills are mortised and pegged with wooden pegs. The present facade is the west elevation; however, according to the records of a local historian, Jill Garrett, the nineteenth-century facade was the east elevation.

A circa 1930 wooden fence and two old mill stones surround the west facade. The gable roof consists of red aluminum shingles. Circa 1935 a porch was added to this facade as part of an overall Colonial Revival movement to update and reorient the house. The porch consists of wood floorboards over a stone and cinder block foundation. The four square wood columns, taken from the Century Club in downtown Columbia, support a flat roof, with balustrade. Two circa 1935 six-over-six windows are on the first floor, flanking an off-center door that reflects the original hall-and-parlor plan of the interior. Two original second story double-hung sash windows are located above the porch roof. Wood steps lead from the porch to the ground level.

The north elevation has a flagstone chimney on the gable end. One window, added in 1935, is to the right of the chimney on the first floor. Two small single pane square windows, circa 1935, symmetrically flank the chimney on the second floor. A first floor addition, also circa 1935, now stands in place of the original front porch and contains an additional window and French doors leading to a landscaped stone patio. The gable roof of this addition runs east to west and consists of metal shingles.

The south elevation has the matching exterior gable end stone chimney, with two original windows flanking the chimney on the first floor and two small square four-pane windows flanking the chimney on the second floor. This elevation contains the basement entrance. A circa 1935 addition stands in place of the original front porch to the east of the chimney. The addition contains two full size windows and one smaller one, as well as a door that opens onto a small porch. Wood steps lead from the porch to the ground level. The foundation of the porch consists of cinder block.

United States Department of the Interior  
National Park Service

# National Register of Historic Places Continuation Sheet

Prewitt-Amis-Finney House, Maury Co., TN

Section number 7 Page 2

---

The east elevation was once the front facade, but presently shows two additions; one that dates circa 1935, when the dwelling was modernized in Colonial Revival fashion, the second, circa 1960, when a bedroom was added. The 1935 addition has a gable roof, that runs from east to west; it contains the dining room, kitchen and laundry room. On the north side, this addition has two symmetrically placed double-hung sash windows. The east side of the addition has a symmetrically placed double-hung sash window. The circa 1960 addition has a flat roof, with two paired double-hung sash windows.

The interior retains its historical integrity as a hall-and-parlor plan house and as a Colonial Revival style conversion of a farmhouse, circa 1935. The first floor of the hall-and-parlor section has two rooms. The north room measures 17' x 13' and the south room measures 17' x 15'. A three-foot- wide doorway separates the two spaces. Both of the original stonework fireplaces are intact. The vernacular style mantel in the north room is believed to date circa 1810, but it may belong to the mid-nineteenth century. The south room's mantel dates to the Colonial Revival conversion of the house, circa 1935. The white ash floorboards in these two rooms are original, as are the low-beamed ceiling beams. Each room has a doorway to the east, the site of the original front porch. An original boxed staircase in the northwest corner of the first floor leads to the second floor bedrooms. The second story rooms of the hall-and-parlor section are also intact, with measurements roughly similar to those on the first floor. The door on the stairway as well as the stairs themselves are original. The second floor also has the original ash floorboards as well as the original interior poplar siding and ceiling beams. All of the windows are original to circa 1935. In the south room, there is one window facing west and two facing east. The north room has one on the east and one on the west.

The attic still has some original wooden frame beams, although some were replaced in the circa 1935 Colonial Revival conversion of the dwelling. The original wooden panels remain on the walls of the attic; they have square cut nails. The basement consists of a dirt floor and is formed by the house's stone foundation. Wood beams were added at a later date to provide additional support.

The Colonial Revival section of the dwelling contains five spaces: a hallway, bathroom, dining room, kitchen, and laundry room. These rooms demonstrate the modernization of the dwelling with indoor plumbing and electricity. They retain their original appearance, except for the addition of modern French doors on the north side of the dining room in 1995.

Circa 1960, the owners made a final addition, a large modern bedroom on the southeast corner of the dwelling. This room also retains its appearance from the time of its original construction and continues to function as a bedroom. The house is an excellent example of a hall-and-parlor plan dwelling. Typically, the hall portion was the primary living space for the family where most of social interaction and cooking took place while the parlor served as the sleeping area. The house retains the original flagstone chimneys on the gable ends. The historical integrity of the hall-and-parlor portion has not been affected by the additions.

United States Department of the Interior  
National Park Service

# National Register of Historic Places Continuation Sheet

Prewitt-Amis-Finney House, Maury Co., TN

Section number 7 Page 3

---

The nominated property contains a contributing outbuilding and contributing site. The Amis family cemetery contains three gravestones, marking the graves of John, Mary, and Josiah Amis, who were buried at this location in 1852. The cemetery is a contributing site (C).

The garage is a white-painted frame building with a metal-covered gable roof, circa 1935, and is a contributing building (C)

United States Department of the Interior  
National Park Service

# National Register of Historic Places Continuation Sheet

Section number 7 Page 4

Prewett-Amis-Finney House, Maury Co., TN

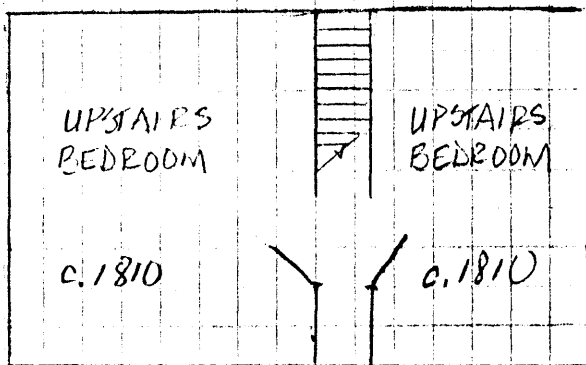
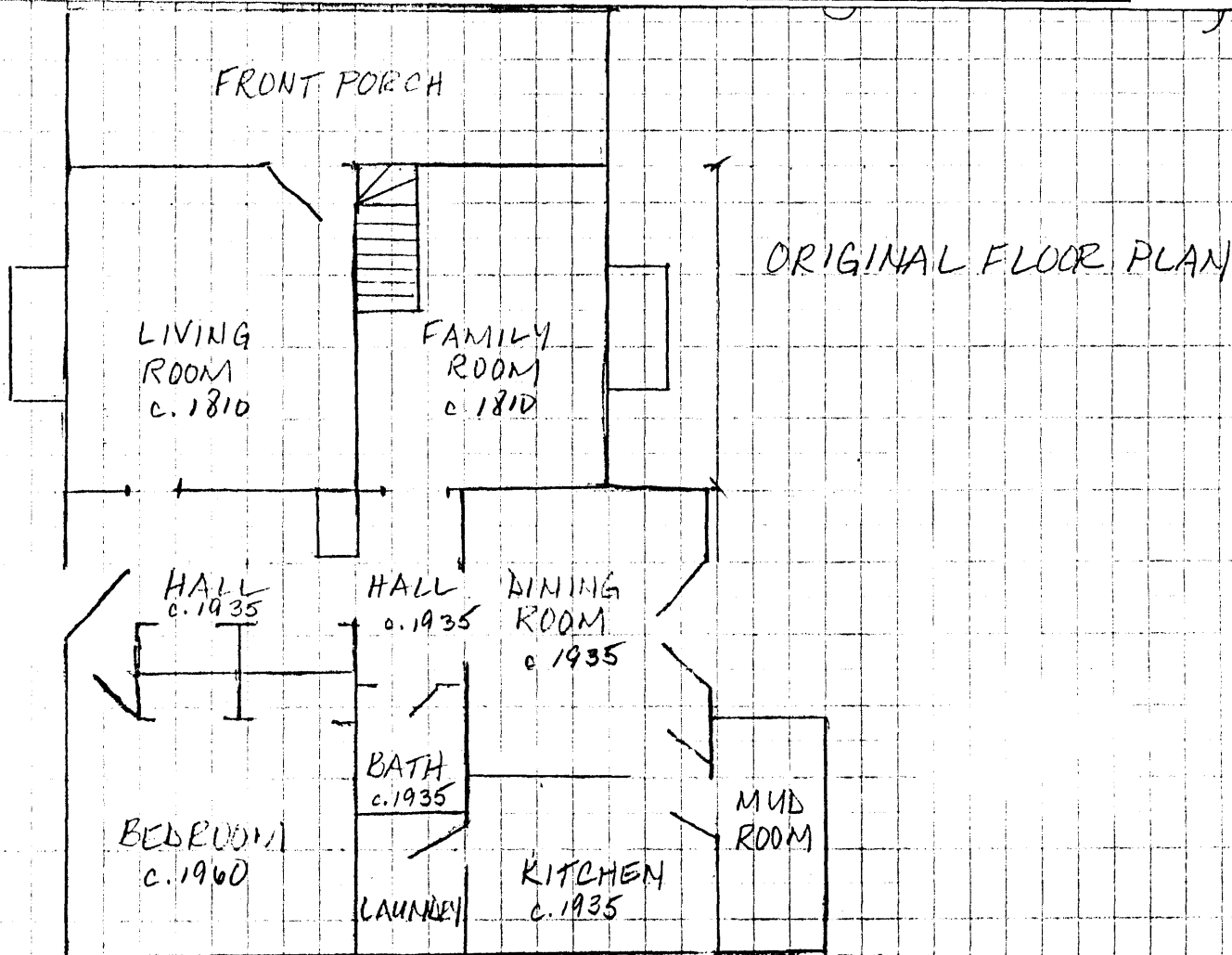

ATTIC & SECOND FLOOR  
IDENTICAL PLAN  
(STAIRS TO ATTIC  
ARE IN SAME  
LOCATION AS FIRST  
FLOOR PLAN)



United States Department of the Interior  
National Park Service

# National Register of Historic Places Continuation Sheet

Prewett-Amis-Finney House, Maury County, TN

Section number 8 Page 5

---

## VIII. SIGNIFICANCE

The Prewett-Amis-Finney House, is located in the southeastern corner of Maury County approximately two miles south of Culleoka, Tennessee and is eligible for the National Register of Historic Places under Criterion C for its architectural significance as a hall-and-parlor house that was altered to reflect the Colonial Revival movement of the 1930s. The property is noteworthy and illustrates the manner in which the present family preserved a hall-and-parlor dwelling within the context of the Colonial Revival style.

It is considered to be the first hall-and-parlor house to be built in the county and is believed to be the only frame hall-and-parlor dwelling left in Maury County from the early settlement era. The hall-and-parlor plan shows the influence of settlers migrating from Virginia and Pennsylvania to East Tennessee in the late eighteenth century. As Middle Tennessee began to acquire settlers in the first decade of the nineteenth century, they introduced the hall-and-parlor plan to the region's traditions of rural domestic architecture.<sup>1</sup> The hall-and-parlor characteristics of the dwelling have been well preserved, including the spacing of windows and doors, the stone gable end chimneys, the original room dimensions, floor boards, and the boxed staircase.

The dwelling was home to some of the earliest settlers of the county and is in close proximity to the Davis Ford Road, an important route of early settlement in the area. The original owners made a considerable investment by building such a permanent and durable home in a frontier area only three years after the county was founded.

Lemuel Prewett first bought the land in 1806, paying one thousand dollars for the initial one thousand acres of his property. He built the house in 1810.<sup>2</sup> Prewett's farming practices pioneered the practice of breeding and raising mules being the first in the county to begin this venture becoming an important agricultural product in Maury County. Lemuel and his wife Elizabeth had twelve children. Their daughter Pheobe was the first settler born south of the Duck River.<sup>3</sup> Two of their sons, Abner and Elisha, served in the Creek War and fought at Horseshoe Bend.<sup>4</sup> John Brown, a founder of Columbia as the county seat, later lived at the farm with the Prewett family. The Prewetts owned slaves, but the location of the slave cabins is unknown.<sup>5</sup>

Prewett was a leading citizen of the county, serving on the first county court of Maury County. Active in local politics and court proceedings, he also helped neighbors hunt fugitive slaves.<sup>6</sup> After the Creek War, Lemuel sold some of his property to his son Abner, including the house. The entire Prewett family left for Mississippi in 1818, at the time of that state's early settlement era. The next owner was John Amis, a North Carolina native who bought the property from Abner Prewett in 1821.<sup>7</sup> Amis was very active in local politics and served on the county court. In 1842, he built a mill nearby on Fountain Creek. This site also served as a voting precinct for the district.<sup>8</sup>

United States Department of the Interior  
National Park Service

# National Register of Historic Places Continuation Sheet

Prewett-Amis-Finney House, Maury County, TN

Section number 8 Page 6

The 1850 Census lists John and his wife Mary as 75 and 72 years old, with the value of their property estimated at \$9,000, a large sum for that time.<sup>9</sup> John and Mary Amis had six children. They owned sixteen slaves, which made him a farmer of considerable wealth, almost meeting the classic definition of a southern

planter: a person who owned twenty or more slaves. John, Mary, and one of their sons, Josiah, all died in the cholera epidemic of 1852 and were buried in a family cemetery on the property, which is still extant. At the time of his death, the property was surveyed and recorded as having 601 acres.

After John and Mary's death in 1852, daughter Elizabeth Amis Cheatham and her husband John Cheatham acquired the farm, house, and mill.<sup>10</sup> A neighbor, George W. Pullen, ran the mill until 1919 and the road in front of the house bears his name.<sup>11</sup> In 1935, the dilapidated house and property was sold to James I. Finney, Sr. The mill had been washed away but Finney retrieved the flint mill stones and set them in the front yard of the house.<sup>12</sup> Finney directed a Colonial Revival modernization of the dwelling, which reoriented the facade to face Pullen Mill Road, added a Colonial Revival portico to the new facade, and placed a modern addition with kitchen, dining room, and bathroom on the east elevation. This conversion of the nineteenth century farmhouse reflected the continuing strength of the Better Homes, Better Farms movement of the 1920s as well as emerging popularity of the Colonial Revival movement in Tennessee domestic architecture. By adding historic columns from the demolished Century Club in Columbia as a portico to his dwelling, Finney was engaging in a combination of historic preservation and modernization that typifies the practice of the Colonial Revival in rural Tennessee. The changes were not meant to accurately recreate the original architecture of the house, but merely to suggest it and at the same time make improvements to the dwelling. The house has remained in the Finney family to the present.

The farm is known locally as the Turnhill Farm, a designation that was assigned to the acreage in the 1950s by request of the county government. James I. Finney, Sr., took the suggestion from his young son, James I. Finney, Jr., that the property should reflect the unique entrance to the farm, making a sharp hairpin turn and then driving up the steep incline, be called Turnhill Farm.<sup>13</sup>

The dwelling is still in a rural setting overlooking the Fountain Creek valley. The house was home to some of the area's earliest settlers and leading citizens. Its location and architecture documents preferences common in the early settlement era in Maury County. The Prewett-Amis-Finney House is an interesting example of the preservation of a hall-and-parlor dwelling within the context of the Colonial Revival style. The rural setting of the house, its original wood floors, walls, ceilings, rooms, and boxed staircase make it a valuable artifact of both history and architecture for the early settlement period of Maury County.

United States Department of the Interior  
National Park Service

# National Register of Historic Places Continuation Sheet

Section number 8 Page 7

Prewett-Amis-Finney House, Maury Co., TN

---

Endnotes

<sup>1</sup>James Patrick, Architecture in Tennessee (Knoxville: University of Tennessee Press, 1981), 61-62.

<sup>2</sup>Jill K. Garrett, Hither and Yon (Columbia, TN: Maury County Historical Society, 1987) 18.

<sup>3</sup>Ibid., 18.

<sup>4</sup>Jill K. Garrett, War of 1812 Soldiers of Maury County, Tennessee. (Columbia, TN: Knox Chapter D.A.R., 161.

<sup>5</sup>Jill K. Garrett, Maury County, Tennessee Historical Sketches. (Columbia, TN, 1967), 23.

<sup>6</sup>Frank H. Smith, History of Maury County, Tennessee Columbia, TN: Maury County Historical Society, 1969), 239.

<sup>7</sup>Garrett, Hither and Yon, 18.

<sup>8</sup>Ibid., 19.

<sup>9</sup>Garrett, Maury County, Tennessee Historical Sketches, 341.

<sup>10</sup>Jill K. Garrett and Marise Lightfoot, Maury County, Tennessee Chancery Court Records, 1810-1850 (1995), 13.

<sup>11</sup>Garrett, Hither and Yon, 19.

<sup>12</sup>Ibid., 19.

<sup>13</sup>Telephone Interview with Sandra Finney. 21 October 1997.

United States Department of the Interior  
National Park Service

# National Register of Historic Places Continuation Sheet

Section number 9 Page 8

Prewett-Amis-Finney House, Maury Co., TN

---

## IX. Bibliography

Garrett, Jill K. Hither and Yon. Columbia, TN: Maury County Historical Society, 1987.

Garrett, Jill K and Marise Lightfoot. Maury County, Tennessee Chancery Court Records, 1810-1860. Vol. I. 1965.

Garrett, Jill K. Maury County, Tennessee Historical Sketches. Columbia, TN, 1967.

Garrett, Jill K. and Marise Lightfoot. Maury County, Tennessee Will Books A, B, C-1, and E. Easley, SC: Southern Historical Press, Inc., 1984.

Garrett Jill K., ed. War of 1812 Soldiers of Maury County, Tennessee. Columbia, TN: Knox Chapter D.A.R., 1976.

Patrick, James. Architecture in Tennessee. Knoxville: University of Tennessee Press, 1981.

Porch, Deane. Maury County Census of 1850. Nashville, 1966.

Smith, Frank H. History of Maury County, Tennessee. Columbia, TN: Maury County Historical Society, 1969.

United States Department of the Interior  
National Park Service

# National Register of Historic Places Continuation Sheet

Section number 10 Page 9

Prewett-Amis-Finney House, Maury County, TN

---

## X. Geographical Data

### Verbal Boundary Description

The nominated property begins at point A along fence line 500 feet, moves east for 500 feet, then south for 500 feet, then west for 500 feet and follows Pullen Mill Road right of way in a northerly direction, as documented in the enclosed Maury County Tax Maps. The tax map for this nomination has the scale 1"=400'. This scale tax map is prepared by the Tennessee State Board of Equalization for rural areas. In the past, the Tennessee Historical Commission used this scale map for nominations and has found that the 1"=400' adequately meets our office needs. The Tennessee Historical Commission does not have the facilities to prepare maps to the scale preferred by the National Park Service.

### Boundary Justification

The nominated property is the site of the Prewett-Amis-Finney House. This acreage includes the house, garage, and Amis family cemetery.

United States Department of the Interior  
National Park Service

# National Register of Historic Places Continuation Sheet

Prewett-Amis-Finney House, Maury Co., TN

Section number 10 Page 10

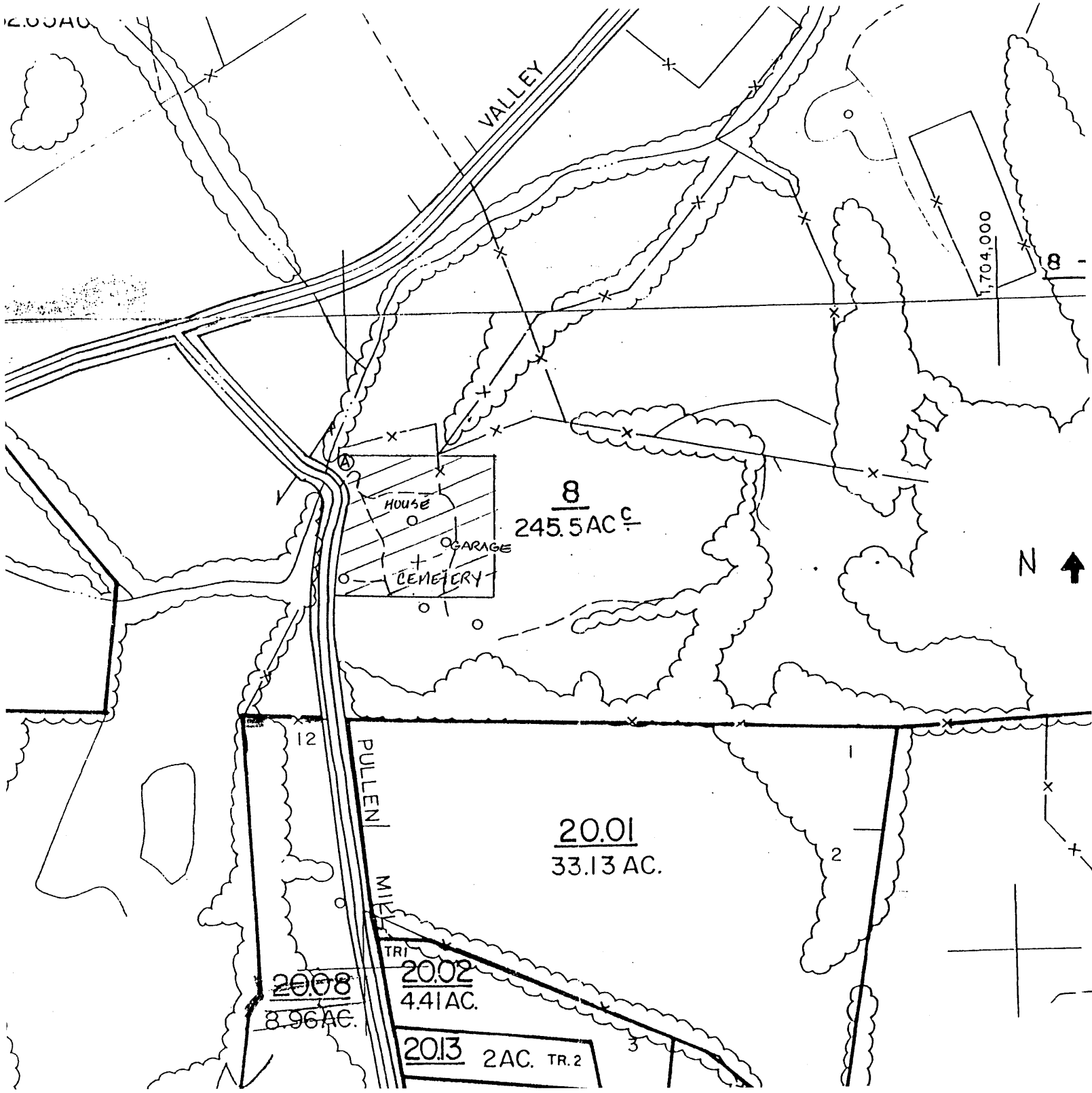

United States Department of the Interior  
National Park Service

# National Register of Historic Places Continuation Sheet

Prewett-Amis-Finney House, Maury Co., TN

Section number          Photos          Page   11  

---

## Photographs

Prewett-Amis-Finney House, Culleoka, TN

Photos by: Carroll Van West

MTSU Center for Historic Preservation

Date: 1995

Negatives: MTSU Center for Historic Preservation

West facade, facing east

1 of 15

North and west elevation, facing southeast

2 of 15

North and east elevation, facing southwest

3 of 15

Partial south elevation

4 of 15

East elevation

5 of 15

Partial south elevation

6 of 15

Parlor, west elevation

7 of 15

Doorway connecting first floor rooms

8 of 15

Second floor, bedroom, east elevation

9 of 15

Second floor, bedroom, west elevation

10 of 15

Southwest corner of the 1935 addition

11 of 15

**United States Department of the Interior**  
National Park Service

# National Register of Historic Places Continuation Sheet

Prewett-Amis-Finney House, Maury Co., TN

Section number \_\_\_\_\_ Photos \_\_\_\_\_ Page 12

---

Utility Room, addition, north elevation  
12 of 15

Southeast corner of the northern addition room  
13 of 15

Dining room, addition, south elevation  
14 of 15

Garage, facing northeast  
15 of 15