

UNITED STATES DEPARTMENT OF THE INTERIOR
NATIONAL PARK SERVICE

FOR NPS USE ONLY
RECEIVED APR 28 1980
DATE ENTERED MAY 28 1980

NATIONAL REGISTER OF HISTORIC PLACES
INVENTORY -- NOMINATION FORM

SEE INSTRUCTIONS IN HOW TO COMPLETE NATIONAL REGISTER FORMS
TYPE ALL ENTRIES -- COMPLETE APPLICABLE SECTIONS

1 NAME

HISTORIC
Pierce County Jail
AND/OR COMMON
Blackshear Jail

2 LOCATION

STREET & NUMBER
Taylor Street
CITY, TOWN
Blackshear
STATE
Georgia
VICINITY OF
Eighth - Billy Evans
COUNTY
Pierce
CODE
13
CONGRESSIONAL DISTRICT
Eighth - Billy Evans
CODE
229
NOT FOR PUBLICATION

3 CLASSIFICATION

CATEGORY	OWNERSHIP	STATUS	PRESENT USE
<input type="checkbox"/> DISTRICT	<input checked="" type="checkbox"/> PUBLIC	<input type="checkbox"/> OCCUPIED	<input type="checkbox"/> AGRICULTURE
<input checked="" type="checkbox"/> BUILDING(S)	<input type="checkbox"/> PRIVATE	<input checked="" type="checkbox"/> UNOCCUPIED	<input type="checkbox"/> MUSEUM
<input type="checkbox"/> STRUCTURE	<input type="checkbox"/> BOTH	<input type="checkbox"/> WORK IN PROGRESS	<input type="checkbox"/> COMMERCIAL
<input type="checkbox"/> SITE	PUBLIC ACQUISITION	ACCESSIBLE	<input type="checkbox"/> EDUCATIONAL
<input type="checkbox"/> OBJECT	<input type="checkbox"/> IN PROCESS	<input type="checkbox"/> YES: RESTRICTED	<input type="checkbox"/> ENTERTAINMENT
	<input type="checkbox"/> BEING CONSIDERED	<input type="checkbox"/> YES: UNRESTRICTED	<input checked="" type="checkbox"/> GOVERNMENT
		<input type="checkbox"/> NO	<input type="checkbox"/> RELIGIOUS
			<input type="checkbox"/> SCIENTIFIC
			<input type="checkbox"/> INDUSTRIAL
			<input type="checkbox"/> MILITARY
			<input checked="" type="checkbox"/> OTHER: Storage

4 OWNER OF PROPERTY

NAME
Harry G. Adams, Mayor
STREET & NUMBER
Blackshear City Hall

CITY, TOWN
Blackshear
VICINITY OF
STATE
Georgia 31516

5 LOCATION OF LEGAL DESCRIPTION - At the time ownership was transferred from Pierce County to the City of Blackshear, no deed was registered.

COURTHOUSE, REGISTRY OF DEEDS, ETC.
STREET & NUMBER
CITY, TOWN
STATE

6 REPRESENTATION IN EXISTING SURVEYS

TITLE
An Inventory of Historical Sites in the Southeast Georgia Area
DATE
Summer, 1976
DEPOSITORY FOR SURVEY RECORDS
Southeast Georgia Area Planning and Development Commission
CITY, TOWN
Waycross
STATE
Georgia
This has not been determined eligible.
FEDERAL STATE COUNTY LOCAL

7 DESCRIPTION

CONDITION

EXCELLENT
 GOOD
 FAIR

DETERIORATED
 RUINS
 UNEXPOSED

CHECK ONE

UNALTERED
 ALTERED

CHECK ONE

ORIGINAL SITE
 MOVED DATE _____

DESCRIBE THE PRESENT AND ORIGINAL (IF KNOWN) PHYSICAL APPEARANCE

The Blackshear Jail is a two-story, brick, 32'X30' rectangular building. Three sides of the slightly sloped roof are enclosed by a brick parapet wall. Located in the center of the main facade is a three story tall square tower that is surmounted by ornamental brick and stonework. Even though the walls are layed in common bond, corbeled brickwork is used extensively for ornamentation. The building's two chimneys are located in the centers of the northwest and southeast elevations, flush with the parapet wall.

Windows on both the first and second floors, as well as the main entrance, feature segmented arches with radiating voussours. These are each accented by brick dripstones. Only the small windows in the second story tower room have flat lintels.

The interior has walls of smooth plaster and ceilings of vaulted corrugated metal. The floors are of concrete, the upper one being supported by the vaulted metal work. On the second floor, two of the original cells are still in place. These 7'X7' cells are constructed of lapped metal strips welded together and were built to house four prisoners each.

There have been only a few changes made since the jail was completed in 1894. A one story, frame porch with a hipped roof has been added to the main facade. The northwestern end of this porch has since been enclosed to add another room to the structure.

The most dramatic change in the appearance of the building has occured in recent years. In the early seventies, a 1½ story, concrete block addition was made to the southeast elevation. This addition houses the two fire trucks of the local volunteer fire department. About this same time, a small concrete block addition was made to the northern corner of the original structure to house a bathroom. Though both of these additions are architecturally non-contributing, they do not detract from the historic value of the structure.

8 SIGNIFICANCE

PERIOD		AREAS OF SIGNIFICANCE -- CHECK AND JUSTIFY BELOW			
<input type="checkbox"/> PREHISTORIC	<input type="checkbox"/> ARCHEOLOGY-PREHISTORIC	<input type="checkbox"/> COMMUNITY-PLANNING	<input type="checkbox"/> LANDSCAPE ARCHITECTURE	<input type="checkbox"/> RELIGION	
<input type="checkbox"/> 1400-1499	<input type="checkbox"/> ARCHEOLOGY-HISTORIC	<input type="checkbox"/> CONSERVATION	<input type="checkbox"/> LAW	<input type="checkbox"/> SCIENCE	
<input type="checkbox"/> 1500-1599	<input type="checkbox"/> AGRICULTURE	<input type="checkbox"/> ECONOMICS	<input type="checkbox"/> LITERATURE	<input type="checkbox"/> SCULPTURE	
<input type="checkbox"/> 1600-1699	<input checked="" type="checkbox"/> ARCHITECTURE	<input type="checkbox"/> EDUCATION	<input type="checkbox"/> MILITARY	<input type="checkbox"/> SOCIAL/HUMANITARIAN	
<input type="checkbox"/> 1700-1799	<input type="checkbox"/> ART	<input type="checkbox"/> ENGINEERING	<input type="checkbox"/> MUSIC	<input type="checkbox"/> THEATER	
<input checked="" type="checkbox"/> 1800-1899	<input type="checkbox"/> COMMERCE	<input type="checkbox"/> EXPLORATION/SETTLEMENT	<input type="checkbox"/> PHILOSOPHY	<input type="checkbox"/> TRANSPORTATION	
<input type="checkbox"/> 1900-	<input type="checkbox"/> COMMUNICATIONS	<input type="checkbox"/> INDUSTRY	<input type="checkbox"/> POLITICS/GOVERNMENT	<input checked="" type="checkbox"/> OTHER (SPECIFY) Local History	
		<input type="checkbox"/> INVENTION			

SPECIFIC DATES 1894

BUILDER/ARCHITECT Pauly Jail Building and Manufacturing Company

STATEMENT OF SIGNIFICANCE

The significance of the Blackshear Jail lies in its architectural styling as well as its important place in local history. The architectural significance is due to its fireproof construction, the use of ornamental brickwork unique in the area, and the use of a nationally known jail works. In local history, it is significant to Blackshear and Pierce County because it served as the county jail for thirty-two years and then served the next fifty years as the city jail.

The authorization for the construction of the jail came when the county commissioners deemed an earlier wood and metal jail, built in 1882, insufficient for the needs of the county. In late 1893, it was decided that the new jail should be a two-story, brick structure with room enough for the jail keeper to live on the first floor. The construction contract was let in the spring of 1894 to the Pauly Jail Building and Manufacturing Company of St. Louis, Missouri, noted jail builders. The building was completed in the fall of 1894 at a cost of \$4,992.

The facility served as the county jail from 1894 until 1926. Since the needs of the county once again surpassed the capacity of the building, a new jail was built in 1926 on land closer to the county courthouse. When the move was completed, the City of Blackshear received the building, which it used as a city jail until 1976. During that time it was also used as police headquarters. In 1976, the city and county began using the same facility and the old jail has been vacant since then.

When the county commissioners were considering the proposal for construction of a new jail, the thought of prisoner safety was as paramount as that of prisoner security. In 1880, a wooden jail was completely destroyed by fire in Blackshear. Fortunately the only prisoner at the time escaped injury. Due to a lack of sufficient funds, this jail was replaced in 1882 with another wooden structure. This building did, however, take into account the danger of fire and each wall had a 1" metal core. In 1893, when more funds for construction were available, it was decided to make the new jail as safe as possible. Since brick, concrete and steel were the major building materials and the use of wood was kept to a minimum, the structure was virtually fireproof.

Besides safety, the commissioners were also interested in the appearance of the county's newest public building. The design of the jail is representative of the type that was popular for such buildings in Georgia during the latter part of the nineteenth century. This style, however, with its tower centered on the main facade and the ornamental brickwork, was unique in this area.

(Continued)

9 MAJOR BIBLIOGRAPHICAL REFERENCES

Carrol, John. "1880 Blackshear Build, City Jail Has 'Colorful' Past." Brunswick News, July 5, 1979.

Pierce County, Georgia. Pierce Superior Court Minute Book C, p. 538 and p. 640.

----- Tax Map BL-20

(Continued)

UTM NOT VERIFIED

10 GEOGRAPHICAL DATA

ACREAGE NOT VERIFIED

ACREAGE OF NOMINATED PROPERTY .18

Quadrangle Name: Blackshear East, Georgia

UTM REFERENCES

Quadrangle Scale: 1:24,000

A

1	7	3	8	1	9	4	0	3	4	6	3	6	2	0
ZONE		EASTING				NORTHING								

B

ZONE		EASTING				NORTHING									

VERBAL BOUNDARY DESCRIPTION

The boundary is marked with a heavy black line on the accompanying sketch map. Justification: The nomination includes all land on parcel 17 on Tax Map BL-17 which is all that is historically associated with this property.

LIST ALL STATES AND COUNTIES FOR PROPERTIES OVERLAPPING STATE OR COUNTY BOUNDARIES

STATE	CODE	COUNTY	CODE
STATE	CODE	COUNTY	CODE

11 FORM PREPARED BY

Historic Preservation Section, Department of Natural Resources Contact: Kenneth H. Thomas, Jr.

NAME / TITLE

Randy Shipp, Historic Preservation Planner

ORGANIZATION

Southeast Georgia Area Planning and Development Commission

DATE

December, 1979

STREET & NUMBER

P.O. Box 2049

TELEPHONE

912/285-6097

CITY OR TOWN

Waycross

STATE

Georgia 31501

12 STATE HISTORIC PRESERVATION OFFICER CERTIFICATION

THE EVALUATED SIGNIFICANCE OF THIS PROPERTY WITHIN THE STATE IS:

NATIONAL

STATE

LOCAL

As the designated State Historic Preservation Officer for the National Historic Preservation Act of 1966 (Public Law 89-665), I hereby nominate this property for inclusion in the National Register and certify that it has been evaluated according to the criteria and procedures set forth by the National Park Service.

STATE HISTORIC PRESERVATION OFFICER SIGNATURE

TITLE

Elizabeth A. Lyon

Elizabeth A. Lyon
Acting State Historic Preservation Officer

DATE

4/21/80

FOR NPS USE ONLY

I HEREBY CERTIFY THAT THIS PROPERTY IS INCLUDED IN THE NATIONAL REGISTER

W. Ray Price

DATE

5/28/80

DIRECTOR, OFFICE OF ARCHAEOLOGY AND HISTORIC PRESERVATION

KEEPER OF THE NATIONAL REGISTER

ATTEST

Carol Dubois

DATE

5/23/80

KEEPER OF THE NATIONAL REGISTER

FHR-8-300A
(11/78)

UNITED STATES DEPARTMENT OF THE INTERIOR
HERITAGE CONSERVATION AND RECREATION SERVICE

**NATIONAL REGISTER OF HISTORIC PLACES
INVENTORY -- NOMINATION FORM**

FOR HCRS USE ONLY	
RECEIVED	APR 28 1980
DATE ENTERED	MAY 28 1980

CONTINUATION SHEET SIGNIFICANCE ITEM NUMBER 8 PAGE 2

The Pauly Jail Building and Manufacturing Company was a well-known firm that specialized in the construction of steel jail cells and jail buildings. Based in St. Louis, Missouri, the firm provided its services to mid-western and southeastern states, for the most part. After almost 100 years in jail construction, the company went out of business in 1964.

Pierce County was created in 1857. This jail late in the nineteenth century replaced, as mentioned, several earlier, less substantial ones. It was here that prisoners were kept while awaiting trial and serving sentences. Many were executed here prior to the re-establishment of the state prison in Milledgeville. It was the only county maintained jail during its heyday. Pierce County's population from 1900-1920 grew from only 8,100 to approximately 12,000 citizens, hence over-loading the capacity of this building.

FHR-8-300A
(11/78)

UNITED STATES DEPARTMENT OF THE INTERIOR
HERITAGE CONSERVATION AND RECREATION SERVICE

**NATIONAL REGISTER OF HISTORIC PLACES
INVENTORY -- NOMINATION FORM**

FOR HCRS USE ONLY
RECEIVED APR 28 1980
DATE ENTERED MAY 28 1980

CONTINUATION SHEET BIBLIOGRAPHY ITEM NUMBER 9 PAGE 2

"The New Jail." The News and Signal, May 17, 1894.

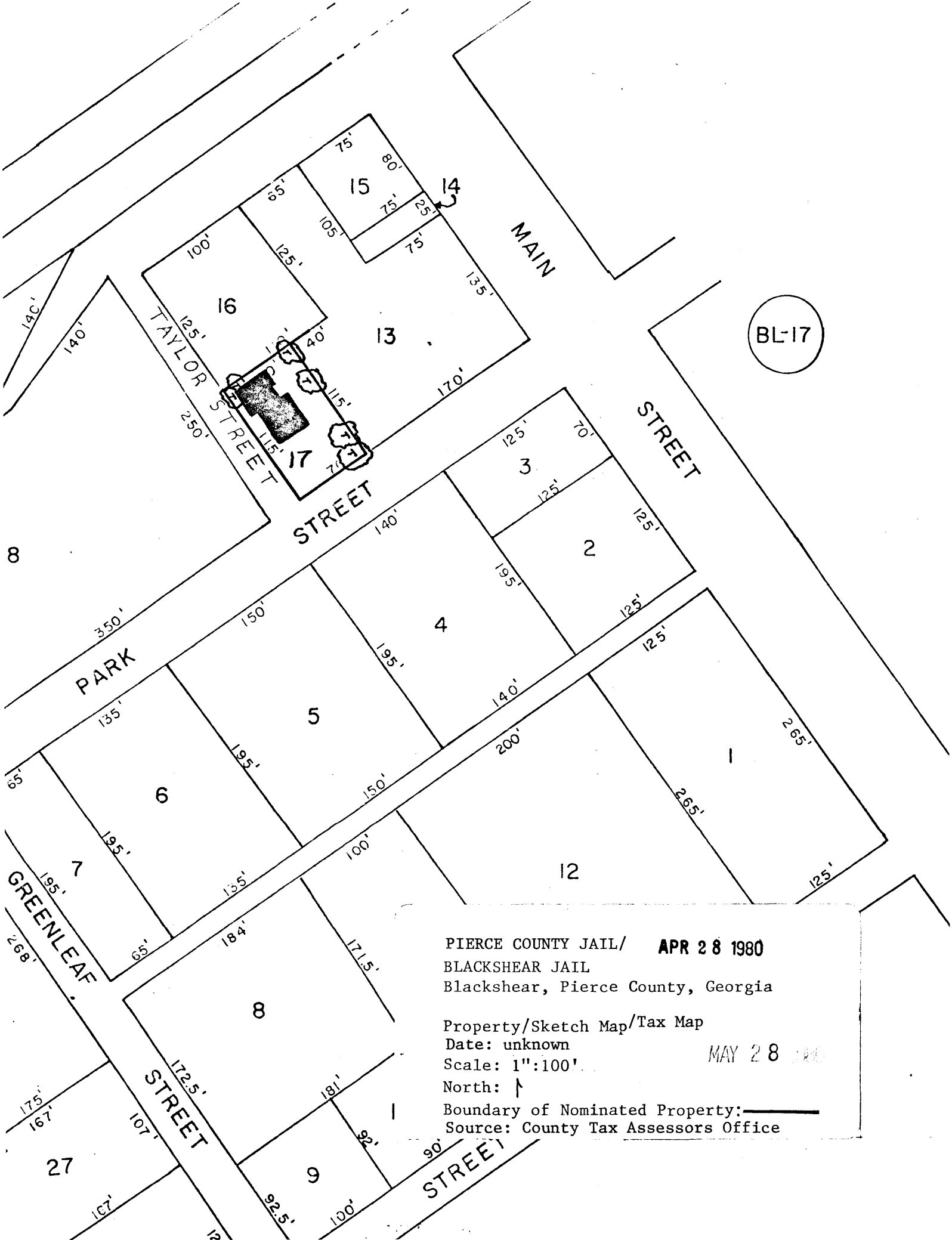

BL-17

PIERCE COUNTY JAIL/ APR 28 1980
 BLACKSHEAR JAIL
 Blackshear, Pierce County, Georgia

Property/Sketch Map/Tax Map
 Date: unknown
 Scale: 1"=100'
 North: ↑
 Boundary of Nominated Property: _____
 Source: County Tax Assessors Office

MAY 28 1980